

Dadi Autobloccanti con cappuccio in nylon

Domed Cap Nuts with Nonmetallic Insert

DIN986

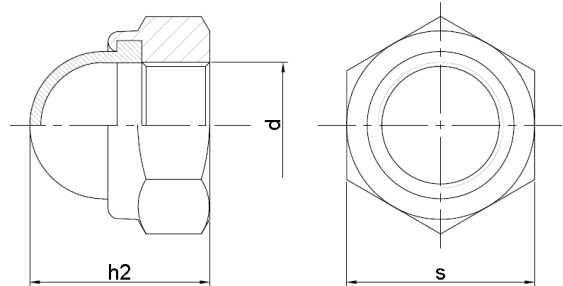

Materiale: stampati in acciaio SAE 1010.
 Trattamento superficiale: zincatura bianca

d	s	h2
M6	10	12
M8	13	14

Material: cold forged SAE 1010 steel
Surface Treatment: zinc plated (colourless)